



## MAXIMUM PRODUCTIVITY

- High visibility mast
- Improved front & rear visibility
- Increased steering angle (54°)
- Stage V engine



## SAFETY

- Easy entry grab bar
- Anti slip step plate



## OPTIMAL ERGONOMICS

- Spacious legroom
- Adjustable tilt steering column



## EXCELLENT RELIABILITY

- Bottom-sealed overhead guard
- New auxiliary weight
- More cooling capacity
- Engine mounted on auxiliary weight



## GREAT SERVICEABILITY

- Rearranged tilt cylinder
- Toolless removable side panel
- Junction box
- Open hood angle (85°)

### MAIN SPECIFICATIONS

		D20NXP G20NXP	D25NXP G25NXP	D30NXP G30NXP	D33NXP G33NXP	D35NXP G35NXP
Capacity	kg	2,000	2,500	3,000	3,300	3,500
Load centre	mm	500	500	500	500	500
Engine		Kubota / V2403-CR-TE5B (diesel) Kubota / WG2503-L (LPG)				
Output	kw / rpm	42.6 / 2,400 (diesel) 42.9 / 2,700 (LPG)				
STD mast range	mm	3,000-5,000	3,000-5,000	3,000-5,000	3,000-5,000	3,000-5,000
FF mast range	mm	3,210	3,210	3,210	3,210	3,210
FFT mast range	mm	4,270-7,060	4,270-7,060	4,270-7,060	4,270-7,060	4,270-7,060



No downtime of the truck: automatic regeneration  
Light applications: manual regeneration +/- 40 minutes.



Regeneration for light applications every 50 - 100 working hours.



Regeneration can be postponed, if soot exceeds 110%, power will be limited.



DPF does not need to be replaced long as it is regenerated regularly. You just detach the DPF and carry out ash cleaning every 5,000 hours.



18 months standard warranty or 1,500 hours in parts and labour.

You can choose for Power Plus warranty:



Excellent spare parts service from our parts distribution centre in Northampton.

## DEMONSTRATION GUIDE

D/G20NXP  
D/G25NXP  
D/G30NXP  
D/G33NXP  
D/G35NXP



Doosan Industrial Vehicles UK Limited  
12 Kilvey Road  
Brackmills Industrial Estate  
Northampton  
NN4 7BQ  
Tel : 01604 825 600  
Website : www.doosanflt.com

# 1

## Mast



- Neatly arranged hydraulic hoses and chains

High visibility for the operator, increased productivity.



- Doosan masts

Doosan manufactures its own masts, which means we have full control over the design and quality.

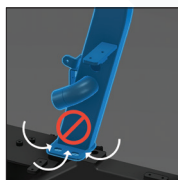

# 4

## Overhead guard / Cabin



- Bottom-sealed overhead guard
- Extends the service interval and guarantees the durability of the engine.



- Doosan developed cabin

The ergonomic Doosan developed cabin has a new design with a curved glass front glass for better upwards view. Components are easily accessible.

# 2

## Truck entrance



- Tilt cylinder inside the chassis

Easy to enter the truck and low maintenance/replacements because the piston is not exposed to dust or other damages.



- Easy entry grab bar and anti slip step plate

Enables easy entry and exit. The wide anti slip step plate keeps the operator safe in all weather conditions.

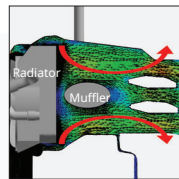

# 5

## Back of the truck



- New auxiliary weight

Lowers the center of gravity. The engine is mounted on the auxiliary weight, whereby the vibration is absorbed, parts durability's extended and durability decline and oil leakage is prevented.



- More cooling capacity

The bigger space between the radiator & muffler streamlines the air flow. The truck can withstand harsh environments and heavy duty applications.

# 3

## Operator compartment



- Ample legroom

The spacious operator compartment makes it comfortable for the operator to drive the forklift for 8 hours a day. The acceleration and brake pedal are positioned to reduce ankle fatigue and increase operator comfort.



- Adjustable tilt steering column

The steering column can be adjusted over a wide range of angles, allowing an optimal posture for the operator.



- High visibility

The combination of the mast and low dashboard provides great front and rear visibility enabling safer driving.

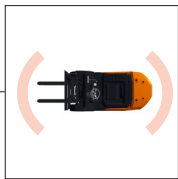

- Increased steering angle (54°)

Easy to manoeuvre in confined spaces.

# 6

## Right side of the truck



- Toolless removable side panel

Grants quick access in need of inspection.



- Open hood angle 85°

More comfortable to service the forklift.



- Engine stage V

Combines DOC and DPF technology providing automatic regeneration even at low rpms. The LPG engine is environmentally clean, very powerful, durable and quiet.

